

AUTO CUT A 101P



CE EN60974-7

CODE	↔	
------	---	--

PA0110	6 m	19.7'	 M14x1
--------	-----	-------	-----------

PA0111	6 m	19.7'	 CENTRAL
--------	-----	-------	-------------

TECHNICAL DATA		
----------------	--	--

	HF	
	0,8 kg	1.76 lb
	500	
	5 bar	
	180 l/min	
	100A	
	75A	
	25÷30 mm	

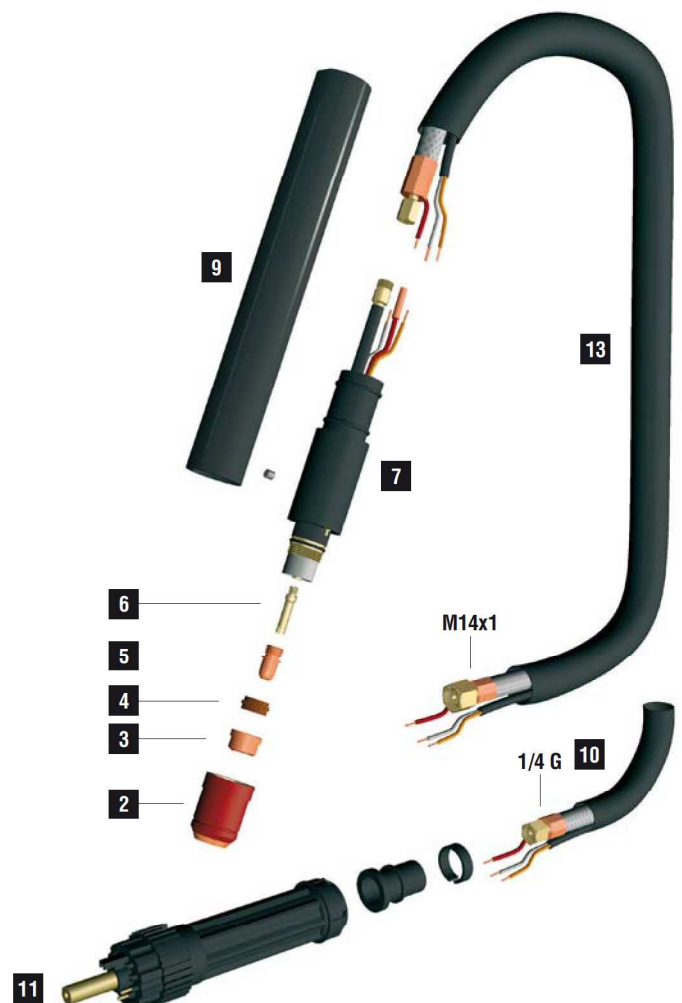
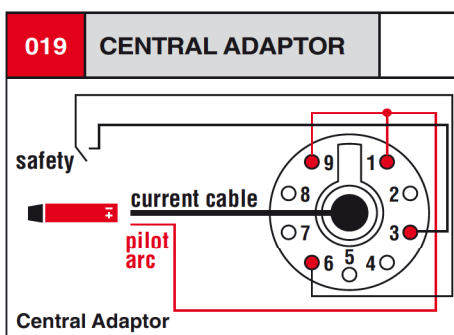
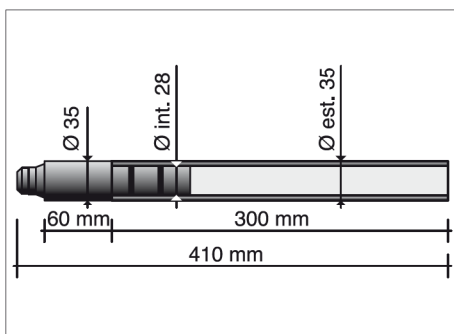

	CODE		Ø		CONTACT		REF		
2	PC0111				44,1 mm			2	
3	PD0101-08		30 A	0,8 mm	.030"	13,7 mm		-	10
3	PD0101-11		60 A	1,1 mm	.043"	13,7 mm		-	10
3	PD0101-14		100 A	1,4 mm	.052"	13,7 mm		-	10
3	PD0101-17		130 A	1,7 mm	.066"	13,7 mm		-	10
3	PD0101-19		140 A	1,9 mm	.074"	13,7 mm		-	10
3	PD0101-30		gouging	3,0 mm	1/8"	13,7 mm		-	10
4	PE0101			plasma diffuser				-	2
5	PR0101		plasma electrode		22 mm			10	
6	FH0562							10	

	CODE	
7	EA0121	O-ring 10
7	PF0115	plasma torch head 1
9	TP0061	1
10	PH0143	6 m - 1/4 G 1
10	QB0097	cover (mt) 100

	CODE	
11	CY0035	cable support 1
11	CY0036	ring 10
11	FY0023	central adaptor 1
13	PH0142	6 m - M14X1 1

STANDARD

CONTACT SHORT

CONTACT LONG